

Invia[®] Liberty[™] Quick Card – Patient

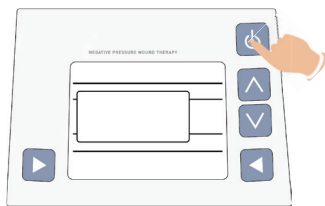

The Invia Liberty Quick Card does not replace the Invia Liberty instructions for use (IFU). For information concerning intended use, contraindications, warnings and cautions please refer to the Invia Liberty Patient instructions for use Ref 200.5787 available with the Invia Liberty pump or at www.medela.com/healthcare.

Basic operating commands



Turn pump ON
Press quickly

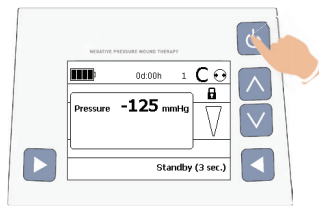

Turn pump OFF
Press for 3 seconds

Place pump in Standby mode

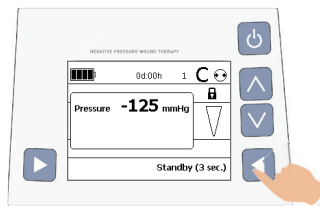

Press for 3 seconds

Resume therapy from Standby mode

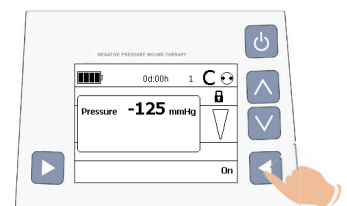

Press quickly

Change canister

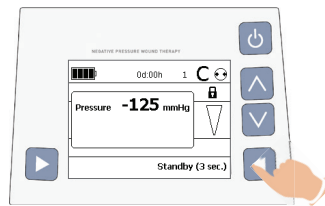

1. Press for 3 seconds to place pump in standby mode.

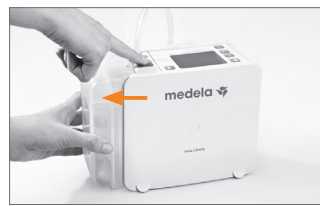

2. Press release button on top of the pump to remove canister.

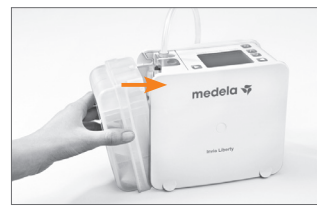

3. Attach new canister by positioning feet first and snapping canister to the pump.

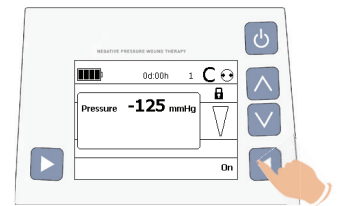

4. Press quickly to resume therapy.
5. Discard used canister according to instructions provided by your healthcare professional.

Troubleshooting

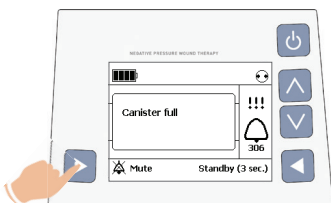

1. Press to temporarily silence the alarm.

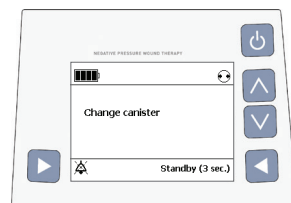

2. Follow instructions on the display or refer to the Alarm Table for troubleshooting. If you cannot solve the problem contact your healthcare professional.

Basic operating commands

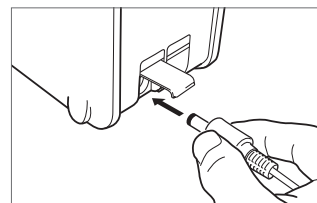

Charge battery

Connect the pump to electrical outlet port. Always charge battery overnight. Battery is fully charged after approximately 4 hours and battery time generally exceeds 10 hours.

Alarm table

	Fault number	Problem description on the display	Troubleshooting on the display	Remarks/potential cause of fault
Warning	401			Recharge the battery either by placing the Invia Liberty pump in the docking station or plug in the charger to the electrical outlet port on the pump. Remaining time of battery is approximately 30 minutes.
	405			If the pump is in Standby mode for more than 5 minutes, an alarm will go off. To continue therapy press “On” [].
	406			Cool Invia Liberty pump down.
Alarm	301			Dressing: – Check dressing for air leakage. Press firmly around the edges of the dressing, around the drain tubing or on the Invia FitPad. – May apply additional film dressing to seal the leaking area. Connectors: – Ensure that the tubing connected to the dressing is connected properly to the canister tubing. – Ensure that the canister tubing is inserted straight into the pump. Canister: – Ensure that the canister is properly inserted, release the canister and reposition. – Ensure that the orange O-ring/gasket, placed beside the canister tubing on the pump is not missing. Additional O-ring is available via Medela representative.
	302			Call your healthcare professional.
	305			Recharge the battery either by placing the Invia Liberty pump in the docking station or plug in the charger to the electrical outlet port on the pump. Remaining time of battery is 15 minutes.
	306			Change the canister, see chapter “Change canister” in the Quick Card or in the instructions for use.
	313			Change the canister, see chapter “Change canister” in the Quick Card or in the instructions for use.
Internal fault				Restart the pump. If internal fault remains, turn off by pressing [> 3 seconds] and contact your healthcare professional.

CAUTION: U.S. Federal law restricts this device to sale by or on the order of a physician.

Medela AG
Lättichstrasse 4b
6341 Baar, Switzerland
www.medela.com

USA
Medela Inc. USA
1101 Corporate Drive
McHenry, IL 60050
USA
Phone +1 877 735 1626
Fax +1 815 307 8942
info-healthcare@medela.com
www.medela-healthcare.us

Canada
Medela Canada Inc.
4160 Sladeview Cres., Unit #8
Mississauga, Ontario, L5L 0A1
Canada
Phone +1 800 435 8316
Fax +1 800 995 7867
info@medela.ca
www.medela.ca