

ARJO
ERGO

Trixie Lift™ Scale

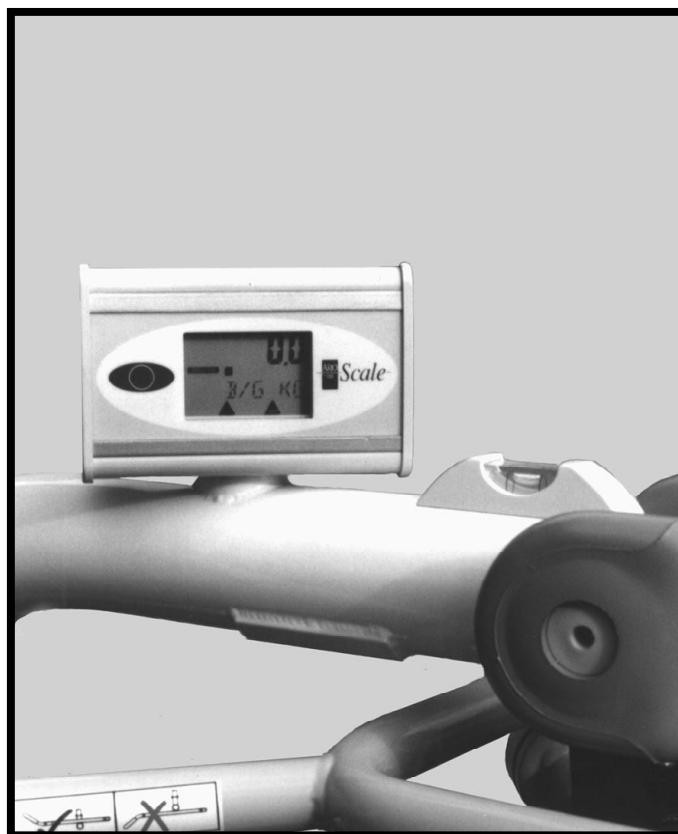

Operating Instructions



4.KT.02/2US 9703

Contents

A *Parts referred to in these Instructions*

B *Introduction*

C *Scale displays*

D *Using your Trixie Lift Scale*

E *Battery Installation / Care of your Scale*

Before using the Trixie Lift Scale familiarize yourself with the various parts as illustrated in fig 1, and thoroughly read and understand these Operating Instructions.

The equipment must be used in accordance with these Instructions, and in conjunction with the Trixie Lift Operating Instructions booklet.

If there is anything you are unsure about, please ask your Arjo representative.

A

Parts referred to in these Instructions

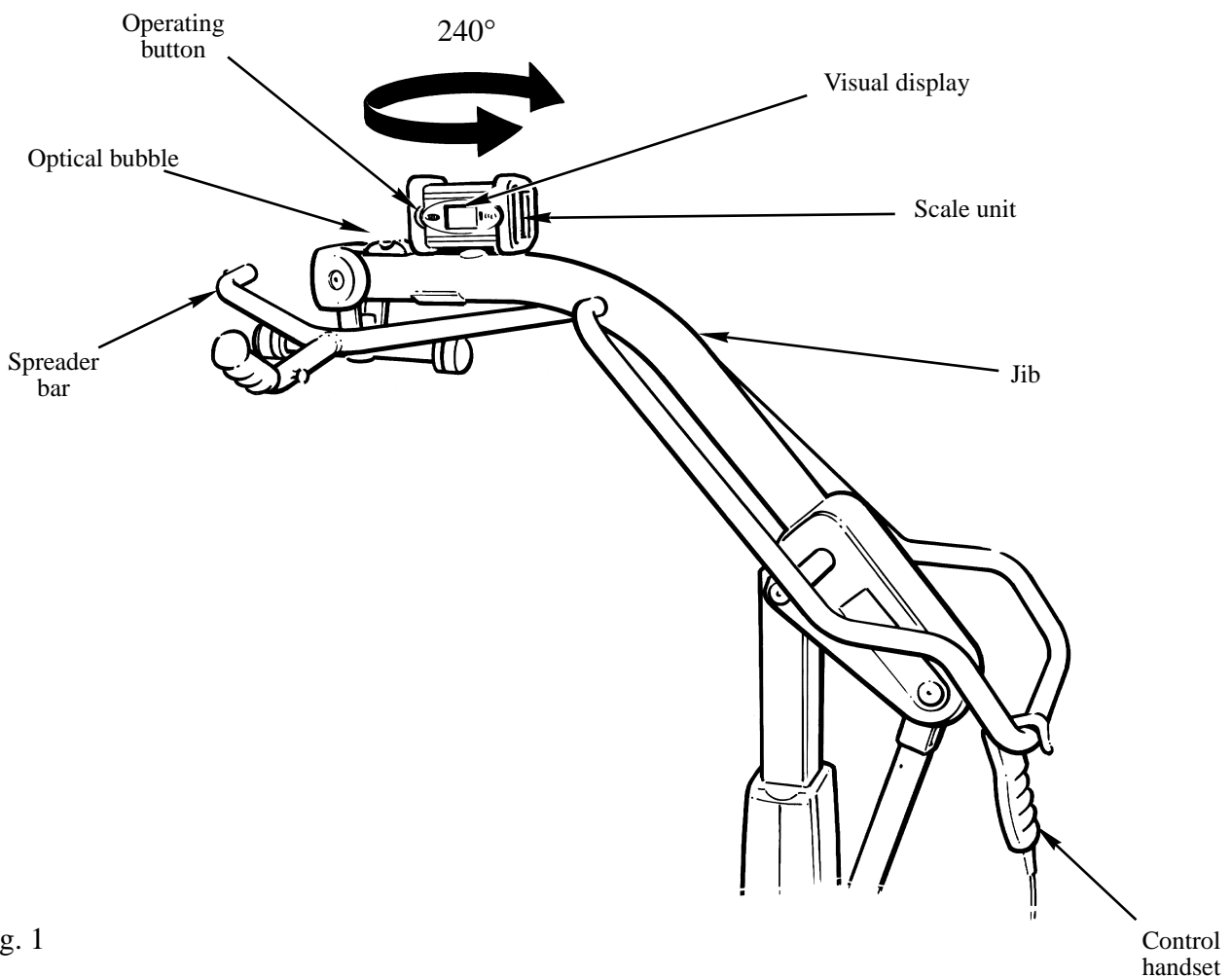

P.1122.2

Fig. 1

The Trixie Lift Scale has been designed to weigh Hospital or Care facility patients under the supervision of trained nursing staff. All other uses must be avoided.

For Hospitals in some countries of Europe, a calibration verification from the appropriate Local Authority is necessary. For period between re-verification contact the Local Authority.

If you want to verify your Scale, contact your Arjo distributor.

Verification

The Scale can be verified by any notified body in the Common Market (EU). The verification is documented by seals attached to the DIN socket, (between the housing and the electronic enclosure - under the cover).

The verification is valid until the date printed on the verification mark of the label.

- **Important:** Do not break the seal. If the seal is broken, a re-examination is necessary. Re-examination must be done by the appropriate authority.

Labels and Seals (See fig. 2)

On the labels attached to the Scale you will find the following information:-

A Rating label

Test certificate number-issued by P.T.B. (Physikalisch-Technische Bundesanstalt).

W1 = Range scale 1:2 - 120kg
W1 = Range scale 1:4 - 264.6lbs

W2 = Range scale 2:4 - 140kg
W2 = Range scale 2:10 - 309lbs

d = actual scale division

e = verified scale division

The values are equal in the scale.

CE marking and green 'M', this scale fulfills the regulations of EN 45501/OIML R76-I.

The certification is according to the 90-384 EEC directive.

B Verification labels/seals

After verification the following signs are to be found on the Scale:-

Two seal marks.

Notified body's verification mark.

C Battery size label

D Serial number label

Unit serial number
'Uncalibrated' unit part number.

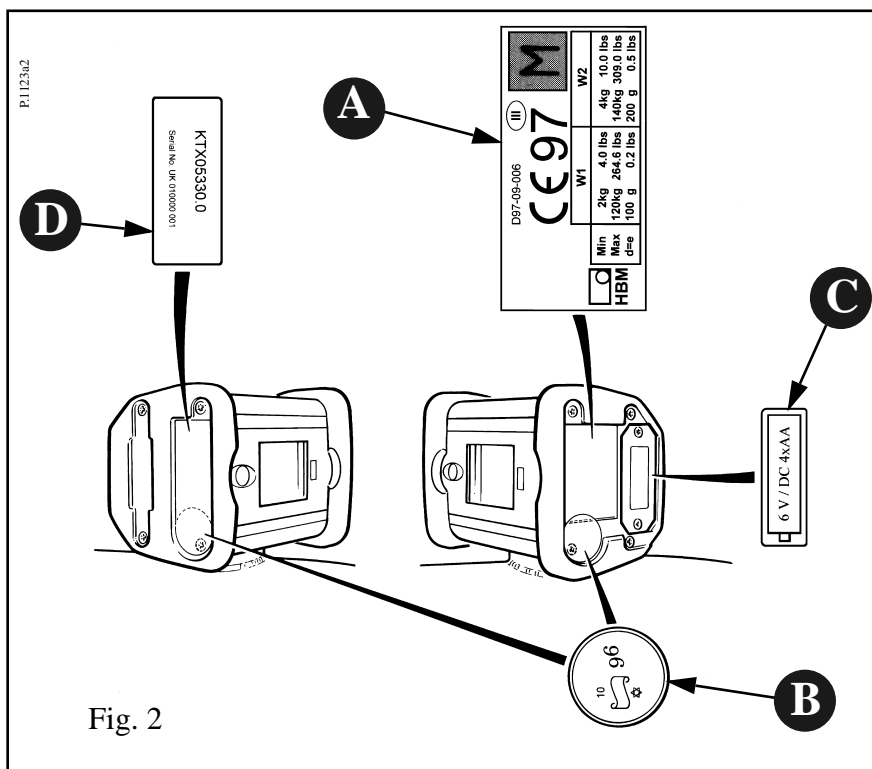

Fig. 2

The Scale has an LCD which displays various numbers and symbols which are explained below. (See fig. 3).

Display symbols/functions

Upper indicator

Shows weight in kilograms or pounds.

(-) shows, when weight is negative. (See section 'D' "Using your Trixie Lift Scale").

Menu Functions

Shows "Operation" function.

Other functions are only available when calibrating.

Mode display

B/G - Gross Weight

NET - Net Weight

Battery symbol

If on - battery power is low. (Approximately 1 hour of operation left).

All digits flashing - batteries are exhausted.

Lock symbol

Input password. (Only available for special and configuration functions. Contact Arjo Service Department if a password is required).

'0 →' symbol

Displayed when the Scale is in zero range, $\pm 25\text{g}$ (0.05lbs).

Dual range symbol

L = Low: 2 - 120kg (4-264.6lbs)

H = High: 4 - 140kg (10-309lbs)

The symbol is displayed for weights over 120 kg (264.6lbs).

Min symbol

Displayed when the load is below 2 kg (4lbs).

Max symbol

Displayed when the load is above 141.8kg (313lbs). If the Scale is overloaded, remove the load immediately. Do not move the Scale/hoist until the symbol has switched off.

Trend indicator

Visual weighing range indicator. Blocks are displayed which increase from left to right as loading increases.

Unit of measurement

The unit of measurement, either 'kg.' or 'lbs.' will be preset before delivery. If, for any reason you need to change from 'kg.' to 'lbs.', press the Operating button for a minimum of 10 seconds. To return to the 'kg.' setting, disconnect the batteries for several seconds, then reconnect.

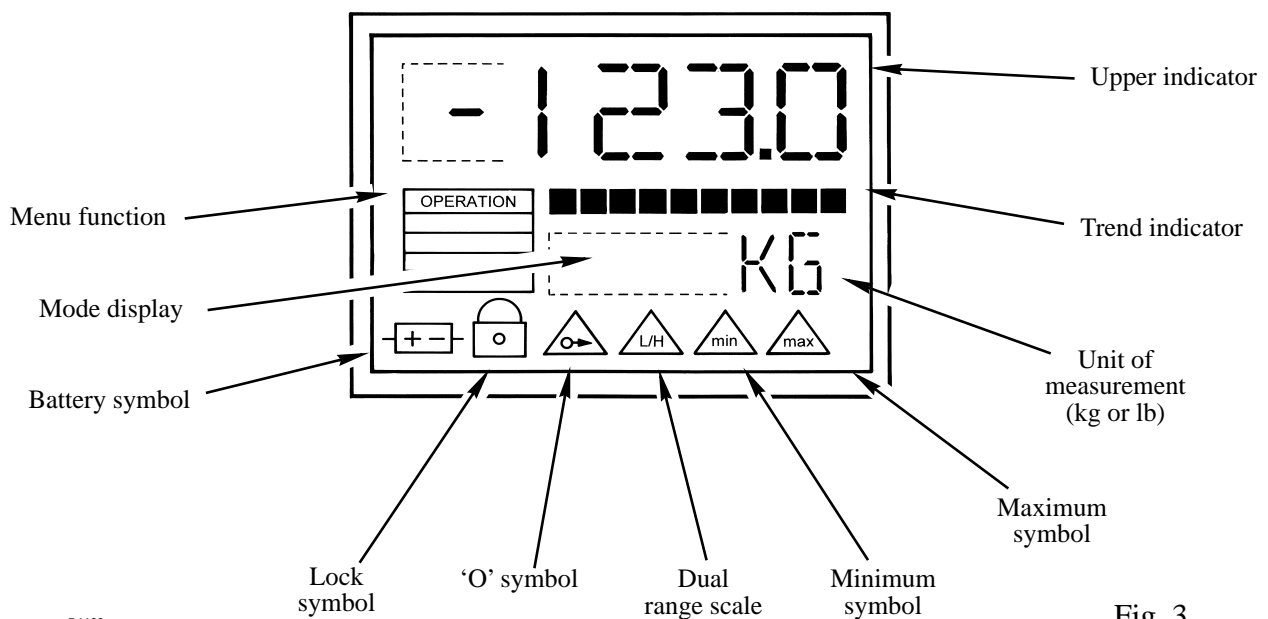

Method 'A' - Weighing before the patient is suspended in the sling

Press the Scale operating button. (See fig. 4).

A display test is performed, all segments are shown for approximately 1 second.

The display will show WAIT and after some seconds will display the mode that the scale is in.

Adjust the jib if necessary using the control handset, (see fig. 1), to ensure that the Scale is horizontal, (when the optical bubble is positioned between the two black lines).

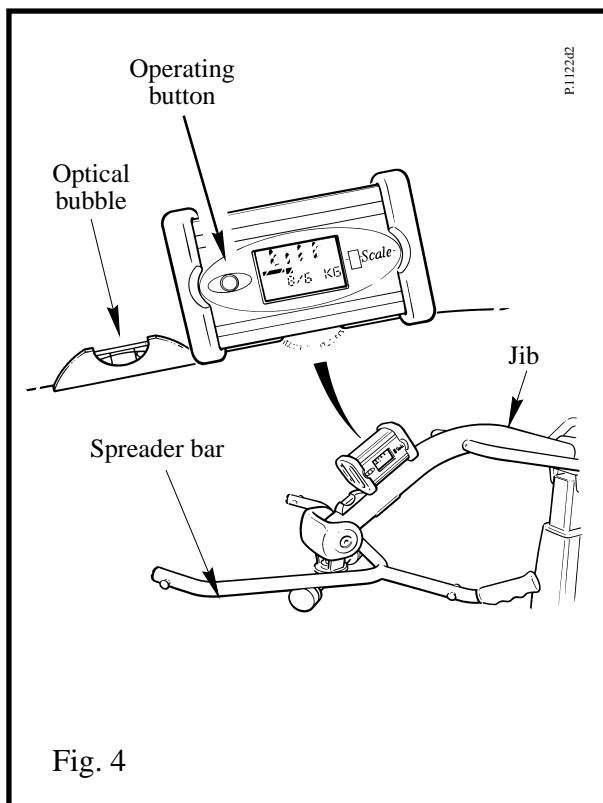

- **Note:** It is essential to carry out weighing operations with the Scale and jib end in the horizontal position. For Verified Scales only:- This is confirmed when the word 'tilt' is no longer displayed on the Scale. (See fig. 4).

Agitated patients will cause the TILT to appear and disappear on the display. The attendant will have to wait until the patient is calm.

Position the spreader bar so that it does not contact the jib, then hang the sling to be used over the spreader bar, (*not the jib*), and press the operating button again.

The Scale will display "NET 0.0". (See fig. 5).

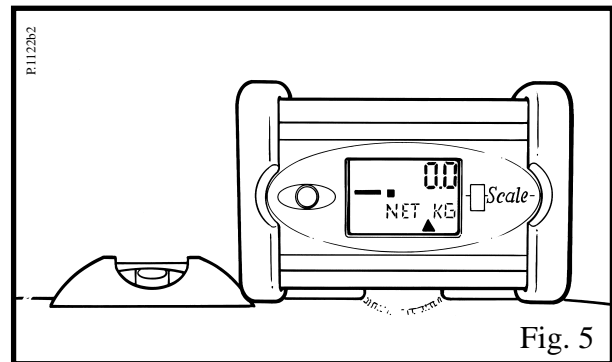

Remove the sling and position it around the patient as in a normal lifting procedure.

Lift the patient until clear of any obstructions e.g. bed, chair, floor etc. until the Scale is horizontal.

Ensure the patient is facing sideways to ensure the spreader bar does not contact the jib.

Do not press the button again - the number displayed will be the weight of the patient.

- **Important:** Do not touch or lean on the patient, jib or spreader bar during weighing. Ensure that no part of the patient, sling or spreader bar touches the jib during weighing, as the jib and spreader bar are integral parts of the weighing equipment.
- **Note:** The Scale, once switched on will operate for 6 minutes. After this time, the Scale will automatically switch off. Should this happen, press the button again.
- **Caution:** Do not overload the Scale. If the Scale unit displays "MAX", remove the patient immediately.

For convenience, the Scale display unit can rotate through 240°, enabling its use from both sides and front of the lift.

- **Note:** The scale can be "re-netted" during operation.

continued...

- **Method 'B'** - Weighing with the patient already suspended in the sling

Ensure the patient is suspended free and clear of any obstructions, e.g. bed, chair, floor etc.

Press the Scale operating button. (See fig. 6).

A display test is performed, all segments are shown for approximately 1 second.

The display will show WAIT and after some seconds will display the mode that the scale is in.

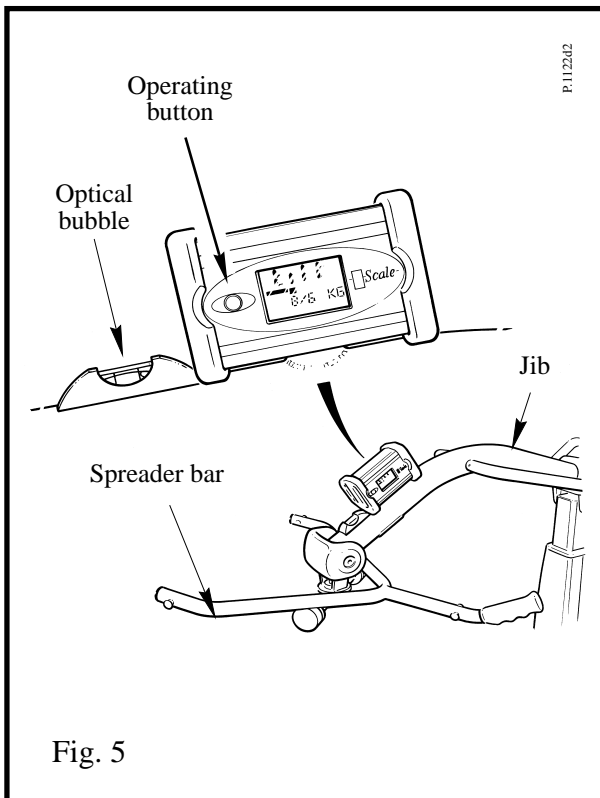

Fig. 5

Adjust the jib if necessary using the control handset, (see fig. 1), to ensure that the Scale is horizontal, (when the optical bubble is positioned between the two black lines).

- **Note:** It is essential to carry out weighing operations with the Scale and jib end in the horizontal position. For Verified Scales only:- This is confirmed when the word 'tilt' is no longer displayed on the Scale. (See fig. 6).

Agitated patients will cause the TILT to appear and disappear on the display. The attendant will have to wait until the patient is calm.

- ! **Ignore the weight displayed, and press the operating button again.**

The Scale will display "NET 0.0". (See fig. 7).

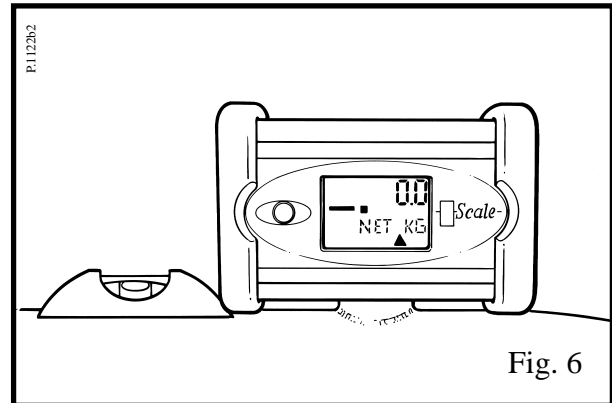

Fig. 6

Lower the patient to a suitable position and remove the sling.

Return the jib to the horizontal position and hang the sling over the spreader bar only.

The weight is displayed, and, although having a minus (-) sign in front of it, is the weight of the patient

Remove the sling.

- **Important:** Do not touch or lean on the patient, jib or spreader bar during weighing. Ensure that no part of the patient, sling or spreader bar touches the jib during weighing, as the jib and spreader bar are integral parts of the weighing equipment.
- **Note:** The Scale, once switched on will operate for 6 minutes. After this time, the Scale will automatically switch off. Should this happen, press the button again.
- **Caution:** Do not overload the Scale. If the Scale displays "MAX", remove the patient immediately.

For convenience, the Scale display unit can rotate through 240°, enabling its use from both sides and front of the hoist.

- **Note:** The Scale can be "re-netted" during operation.

Battery Installation/Change

(See fig. 8)

If the battery symbol is displayed on the Scale LCD, there is enough power left for approximately 1 hour of operation.

To change the batteries:-

Open the battery compartment cover by firstly removing the two screws using a small bladed screwdriver. Remove the cover.

Pull out the battery holder carefully.

Disconnect the push-on connector from the end of the battery holder if necessary.

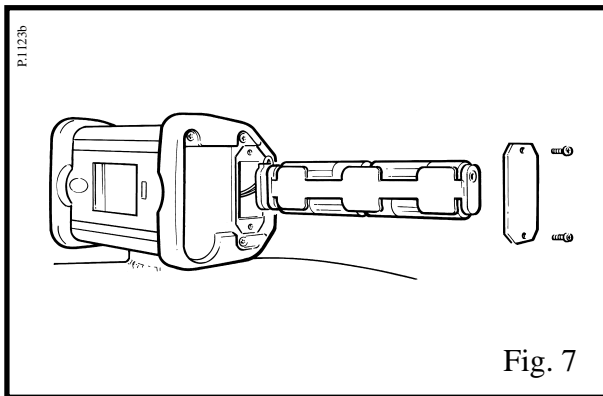

Remove the existing batteries from the battery holder and replace using four 'AA' size batteries or equivalent, ensuring correct polarity.

Replace battery compartment cover, and tighten screws.

When the batteries have been changed, (and the unit of measurement was previously set to *lbs*), the display will reset to *kgs*. To change the units back to *lbs*, if required, press the operating button for a minimum of 10 seconds.

- *Note: If the batteries are inserted incorrectly, they will not damage the circuit board.*

Rechargeable batteries may be used however, the operating time of the scale between charges will be shorter than if non rechargeable batteries are used.

Care of your Scale

The Scale is adapted to the same conditions as the Trixie Lift. For cleaning instructions, see the relevant section in Trixie Lift Operating Instructions.

Apart from cleaning and battery changing, no other special maintenance should be required.

We strongly advise and warn that only Company Designated Parts, which are designed for the purpose, should be used on equipment and other appliances supplied by the Company, to avoid injuries attributable to the use of inadequate parts.

The Company's Conditions of sale make specific provision confirming no liability in such circumstances.

Our policy is one of continuous development, and we therefore reserve the right to change specifications without notice.

AUSTRALIA

Arjo Hospital Equipment Pty. Ltd.,
P.O. Box 278
Botany,
N.S.W. 2019
Tel. 2-316 4911
Fax. 2-666 3614

BELGIQUE / BELGIË

Arjo Hospital Equipment nv/sa
Nijverheidsweg 10A
BE-9820 MERELBEKE
Tel. 09/231.69.89
Fax. 09/231.34.76

CANADA

Arjo Canada Inc.
53-6535 Millcreek Drive
Mississauga,
ONTARIO
L5N 2M2
Tel. 01-800-665-4831
Fax. 01-800-309-1116

ČESKÁ REPUBLIKA

Arjo Hospital Equipment s.r.o.
Strmá 35
CZ-616 00 BRNO
Tel. 05 754 252
Fax. 05 412 13550

DANMARK

Arjo A/S
Firskovvej 25 B
DK-2800 Lyngby
Tel. 45 93 27 37
Fax. 45 93 41 20

DEUTSCHLAND

Arjo Systeme für Rehabilitation GmbH
Rudolf-Diesel-Straße 5
DE-65719 HOFHEIM-WALLAU
Tel. 06122 8040
Fax. 06122 804160

ESPAÑA

Arjo Spain, S.A.
Constitución 3-5º-2ª
08960 Sant Just Desvern.
BARCELONA
Tel. 93 473 70 50
Fax. 93 473 71 55

FRANCE

Arjo Equipements Hospitaliers S.A.
Central Parc,
4, allée du Sanglier
F-93421 Villepinte Cedex
Tel. 01 49 63 47 00
Fax. 01 48 61 41 42

GREAT BRITAIN

Arjo Ltd.,
St. Catherine Street
Gloucester, GL1 2SL
ENGLAND U.K.
Tel. (01452) 500200
Fax. (01452) 525207

HONG KONG

Arjo Ltd.
2703 APEC Plaza,
49 Hoi Yuen Road,
Kwun Tong, Kowloon,
HONG KONG
Tel. (852)-2508 9553
Fax. (852)-2508 1416

ITALIA

Arjo-Italia S.p.A.
Via Della Marcigliana, 532
IT-00139 ROMA
Tel. 06-87 127 023
Fax. 06-87 120 640

JAPAN

Arjo Japan
Sweden Center Bldg. 6F
6-11-9, Roppongi, Minato-ku
Tokyo 106
JAPAN
Tel. 03-5411-6215
Fax. 03-5411-6214

NORGE

Getinge-Arjo AS
Ole Deviks vei 4
0666 OSLO
Tel. 23 05 11 80
Fax. 23 05 11 99

NEDERLAND

Arjo Nederland B.V.
Laan van Westroyen 6
Postbus 6116
NL 4000 HC TIEL
Tel. 0344 640800
Fax. 0344 640885

ÖSTERREICH

Arjo-Sic GmbH
Mitterweg 60
Postfach 8
A-6026 INNSBRUCK
Tel. 0512 - 281 613
Fax. 0512 - 281 613 75

POLSKA

Arjo Poland Sp.z o.o.,
ul. Walecznych 44,
03-916 WARSZAWA
Tel. 22 616 29 16
Fax. 22 617 76 01

SCHWEIZ / SVIZZERA

Arjo-Sic AG
Wartenbergstrasse 15
Postfach CH-4020
BASEL
Tel. 061-311 97 84
Fax. 061-311 97 42

SVERIGE

Arjo Sverige AB
Box 61
S-241 21 ESLÖV
Tel. 0413-645 00
Fax. 0413-645 83

USA

Arjo Inc.
8130 Lehigh Avenue
Morton Grove,
ILLINOIS 60053
Tel. 847-967-0360
Tel. 800-323-1245
Fax. 888-389-2756

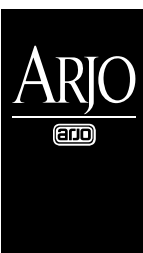

93/42/EEC

If your country is not listed here, please contact your local distributor, or Arjo International AB,
Box 61 241 21 ESLÖV, SWEDEN. Tel +46 413 64500. Fax + 46 413 555586.



FM 21964
ISO 9001 • BS 5750 Part 1 • EN 29001
Arjo Limited • GLOUCESTER • U.K.